

AIRCRAFT PARKING / DOCKING CHART – ICAO

APRON ELEV 6M

TWR: 118.35 PRI  
118.05 SRY  
GROUND: 121.6 PRI  
121.9 SRY

DA NANG/DA NANG INTL (VVDN)

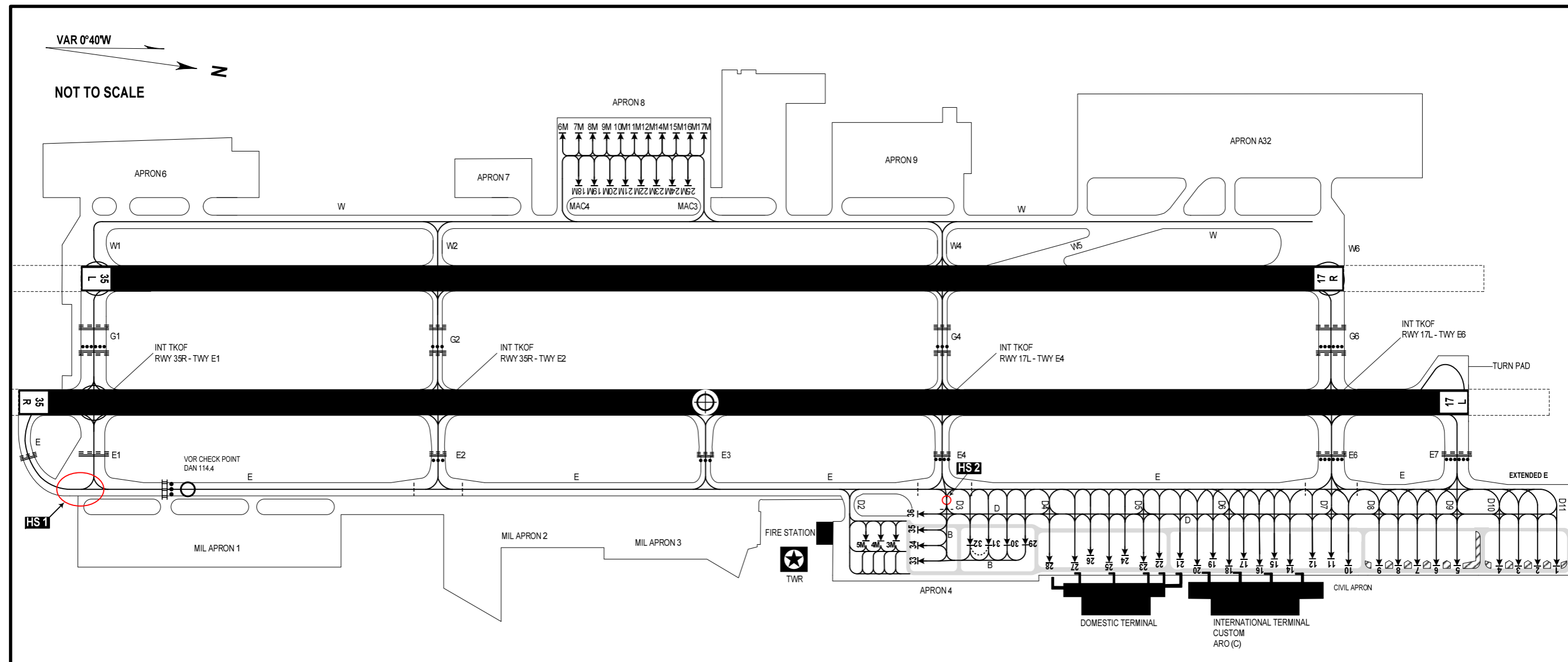

**NOTE FOR CHANGES:**  
\* THE ADDITION OF THE NEW HOT SPOT HS2: THE INTERSECTION OF THE INTO/OUT TAXILANE D3 AND TWY E.

**\* OPERATIONAL PROCEDURES OF STAND:**  
- FOR STANDS 1, 2, 3, 4, 5, 6, 7, 8, 9, 10, 11, 12, 14, 16, 18, 20, 21, 22, 23, 24, 25, 26, 27, 28, 29, 30, 31, 32: USED FOR ACFT CODE C (WINGSPAN UP TO BUT NOT INCLUDING 36m);  
- STANDS 2, 3, 6, 7, 8, 16, 18, 20, 23, 25, 30, 31 MAY BE USED FOR ACFT CODE D/E (WINGSPAN FM 36m UP TO BUT NOT INCLUDING 65m) WHEN THERE IS NO ACFT PARKING AT ADJACENT POSITION NEXT TO STAND;  
- STAND 1 MAY BE USED FOR ACFT CODE D/E WHEN THERE IS NO ACFT PARKING AT STAND 2;  
- STAND 4 MAY BE USED FOR ACFT CODE D/E WHEN THERE IS NO ACFT PARKING AT STAND 3;  
- STAND 5 MAY BE USED FOR ACFT CODE D/E WHEN THERE IS NO ACFT PARKING AT STAND 6;  
- STAND 9 MAY BE USED FOR ACFT CODE D/E WHEN THERE IS NO ACFT PARKING AT STAND 8;  
- STAND 10 MAY BE USED FOR ACFT CODE D/E WHEN THERE IS NO ACFT PARKING AT STAND 11;  
- STAND 14 MAY BE USED FOR ACFT CODE D/E WHEN THERE IS NO ACFT PARKING AT STAND 15;  
- STAND 12 IS ONLY ALLOWED TO BE USED FOR PARKING ACFT WITH WINGSPAN UP TO 28m OR IS ABLE TO BE USED FOR ACFT CODE D (WINGSPAN FM 36m UP TO BUT NOT INCLUDING 52m) WHEN THERE IS NO ACFT PARKING AT STAND 15; STAND 12 IS ONLY ALLOWED FOR PARKING ACFT WITH WINGSPAN UP TO 36m;  
- STAND 27 MAY BE USED FOR ACFT CODE D/E WHEN THERE IS NO ACFT PARKING AT STAND 26; STAND 28 UNTIL ALLOWED FOR PARKING ACFT CODE C (WINGSPAN UP TO BUT NOT INCLUDING 36m);  
- STAND 31 IS ESTABLISHED THE STOP LINE (15m FM THE EXISTING STOP LINE TO THE WEST) AND THE INTERRUPTED TAXILANE FM STAND 31 TO STAND 32 FOR OPERATING ACFT C17, C130...;  
- STANDS 15, 17, 19 ONLY USED FOR ACFT WITH WINGSPAN UP TO 28m WHEN THERE IS NO ACFT WITH WINGSPAN MORE THAN 28m PARKING AT ADJACENT STAND;  
- STANDS 33, 34, 35, 36 ONLY USED FOR ACFT WITH WINGSPAN UP TO 30m. STANDS 33, 34, 35 MAY BE USED FOR ACFT A321 AND EQUIVALENT WHEN ADJACENT STANDS OPERATED FOR ACFT WITH WINGSPAN UP TO 24m;  
- STAND 10 IS USED FOR SPECIAL FLIGHT;  
- STANDS 3M, 4M, 5M:  
+ UNLIMITED OPERATION FOR ACFT WITH WINGSPAN UP TO BUT NOT INCLUDING 30m AND EQUIVALENT: EMBRAER, AT72 ...;  
+ FOR ACFT WITH WINGSPAN FM 30m UP TO BUT NOT INCLUDING 36m (A320/321) AND EQUIVALENT: COMMERCIALY OPERATED MAXIMUM 3 FLIGHT/STAND/DAY. UNLIMITED OPERATION IN CASE OF BEING USED FOR UNLOADED ACFT PARKING OR ACFT PARKING OVERNIGHT.  
- STANDS 7M TO 17M ARE USED FOR ACFT WITH WINGSPAN UP TO 29m;  
- STANDS FROM 18M TO 25M AND STAND 6M ARE USED FOR ACFT UP TO A321 OR EQUIVALENT.  
**NOTE: STAND 1 IS USED AS ISOLATED STAND, WHEN ACFT IS USED IN ISOLATION SITUATION, STANDS 2, 3 AND A PORTION OF TWY E (THE PORTION FM STAND 1 TO STAND 3) ARE NOT USED.**  
\* REFER TO TEXTUAL SECTION FOR OPERATIONAL LIMITATIONS.

**APRON BEARING STRENGTH:**  
- STANDS NR 1, 2, 3, 4, 5, 6, 7, 8, 9: PCN 65/R/A/W/T.  
- STANDS NR 10, 11, 12, 14, 15, 16, 17, 18, 19, 20, 21, 22: PCN 65/R/A/W/T.  
- STANDS NR 23, 24, 25, 26, 27: PCN 67/R/B/W/T.  
- STANDS NR 28, 29, 30, 31, 32, 33, 34, 35, 36: PCN 65/R/A/X/T.  
- STANDS 3M, 4M, 5M: PCN 28/R/B/W/T.  
**TWY WIDTH:**  
- G2, G4, E, W, W2, W4, W5 = 23m  
- E2, E3, E4, E7 = 31m  
- E1 = 57m  
- E, EXTENDED E = 23m  
- W1 = 60m  
- W6 = 152m  
- G1, G6, E6 = 61m  
**TWY BEARING STRENGTH:**  
- G2, G4 = PCN 46/F/B/X/U.  
- W, G1, G6, W1, W2, W4, W5, W6 = PCN 46/R/B/X/U.  
- E1, E2, E3, E4, E6, E7 = PCN 56/R/A/W/T.  
- E = PCN 56/R/A/X/T.  
- EXTENDED E = PCN 65/R/A/W/T.  
**TWY EDGE-LINE LIGHTS:** E, E1, E2, E3, E4, E6, E7, G1, G6.  
**TWY CENTRE-LINE LIGHTS:** NIL

LEGEND	
VOR CHECK POINT	⊙
HOT SPOT AND NUMBER	⊙ HS1
NUMBER OF STAND POSITION	1
RWY - HOLDING POSITION	TYPE A
	TYPE B
TAXILANE MARKING	TO ACFT STAND
	TO CONDITIONAL STAND
INTERMEDIATE-HOLDING POSITION	----
STOP BAR	●●●
VEHICLES AREA	▨
ARP	⊕

CHANGE: NOTE FOR CHANGES.