

RWY	DIRECTION (TRUE)	THR WGS-84	BEARING STRENGTH
17R	172°	16°03'27"N - 108°11'47"E	PCN 44/F/B/X/T
35L	352°	16°01'48"N - 108°12'01"E	
17L	172°	16°03'37"N - 108°11'53"E	PCN 53/R/A/W/T
35R	352°	16°01'45"N - 108°12'09"E	

TWYS WIDTH:

- G2, G4, W, W2, W4, W5, E, EXTENDED E = 23M.
- E2, E3, E4, E7 = 31M.
- E1 = 57M.
- W1 = 60M.
- W6 = 152M.
- G1, G6, E6 = 61M.

TWYS BEARING STRENGTH :

- G2, G4: PCN 46/F/B/X/U.
- E1, E2, E3, E4, E6, E7: PCN 56/R/A/W/T.
- E: PCN 56/R/A/X/T.
- W, G1, G6, W1, W2, W4, W5, W6: PCN 46/R/B/X/U.
- EXTENDED E: PCN 65/R/A/W/T.

APRON BEARING STRENGTH:

- STANDS 1, 2, 3, 4, 10, 11, 12, 14, 15, 16, 17, 18, 19, 20, 21, 22: PCN 65/R/A/W/T.
- STANDS 5, 6, 7, 8, 9: PCN 56/R/A/W/T.
- STANDS 23, 24, 25, 26, 27: PCN 67/R/B/W/T.
- STANDS 28, 29, 30, 31, 32, 33, 34, 35, 36: PCN 65/R/A/X/T.
- STANDS 3M, 4M, 5M: PCN 28/R/B/W/T.

ELEVATIONS AND DIMENSIONS IN METRES
BEARINGS ARE MAGNETIC.

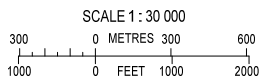
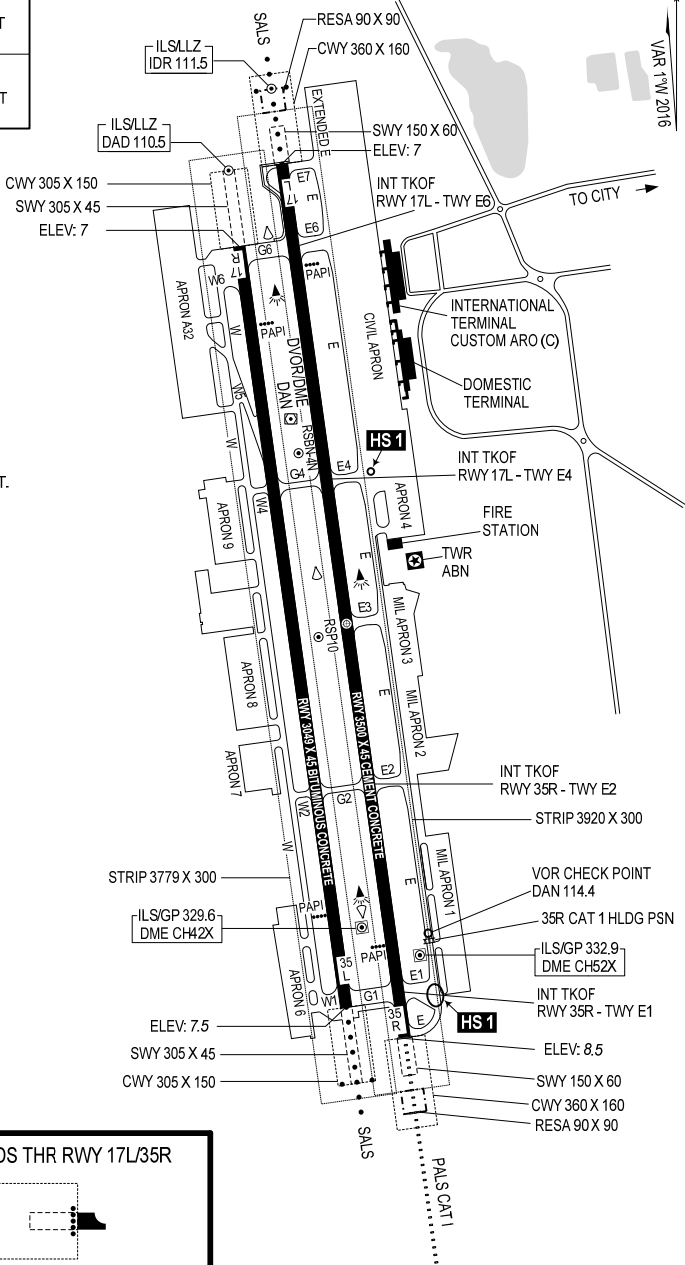

LEGEND	
VOR CHECK POINT	○ DAN 114.4
HOT SPOT AND NUMBER	○ HS 1
WIND DIRECTION INDICATOR (WDI)	↖
BUILDINGS	■
RUNWAY VISUAL RANGE	▽
ARP	⊕

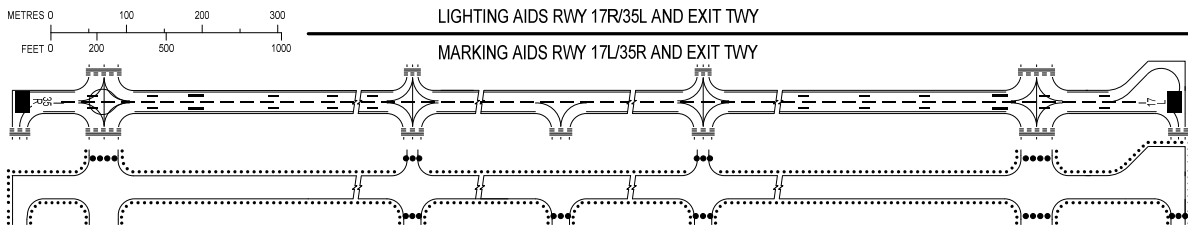
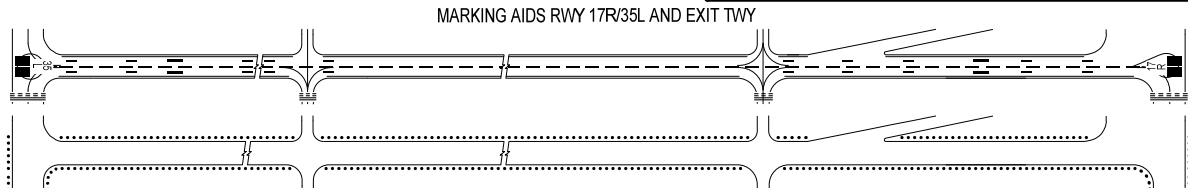
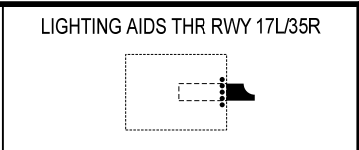
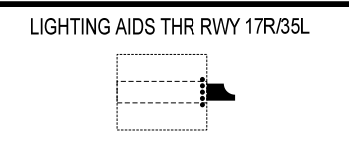

CHANGE: ADDITION OF MID RWY.