

TWR:	118.35 PRI
	118.05 SRY
GROUND:	121.6 PRI
	121.9 SRY

TWYS WIDTH:
 - G2, G4, W, W2, W4, W5, E, EXTENDED E = 23 M.
 - E2, E3, E4, E7 = 31 M.
 - E1 = 57 M.
 - W1 = 60 M.
 - W6 = 152 M.
 - G1, G6, E6 = 61 M.

TWYS BEARING STRENGTH :
 - G2, G4: PCN 46/F/B/X/U.
 - E1, E2, E3, E4, E6, E7: PCN 56/R/A/W/T.
 - E: PCN 56/R/A/X/T.
 - W, G1, G6, W1, W2, W4, W5, W6: PCN 46/R/B/X/U.
 - EXTENDED E: PCN 65/R/A/W/T.

TWY EDGE LINE LIGHTS: E, E1, E2, E3, E4, E6, E7, G1, G6.
 TWY CENTRE-LINE LIGHTS: NIL

ELEVATIONS AND DIMENSIONS IN METRES
 BEARINGS ARE MAGNETIC.

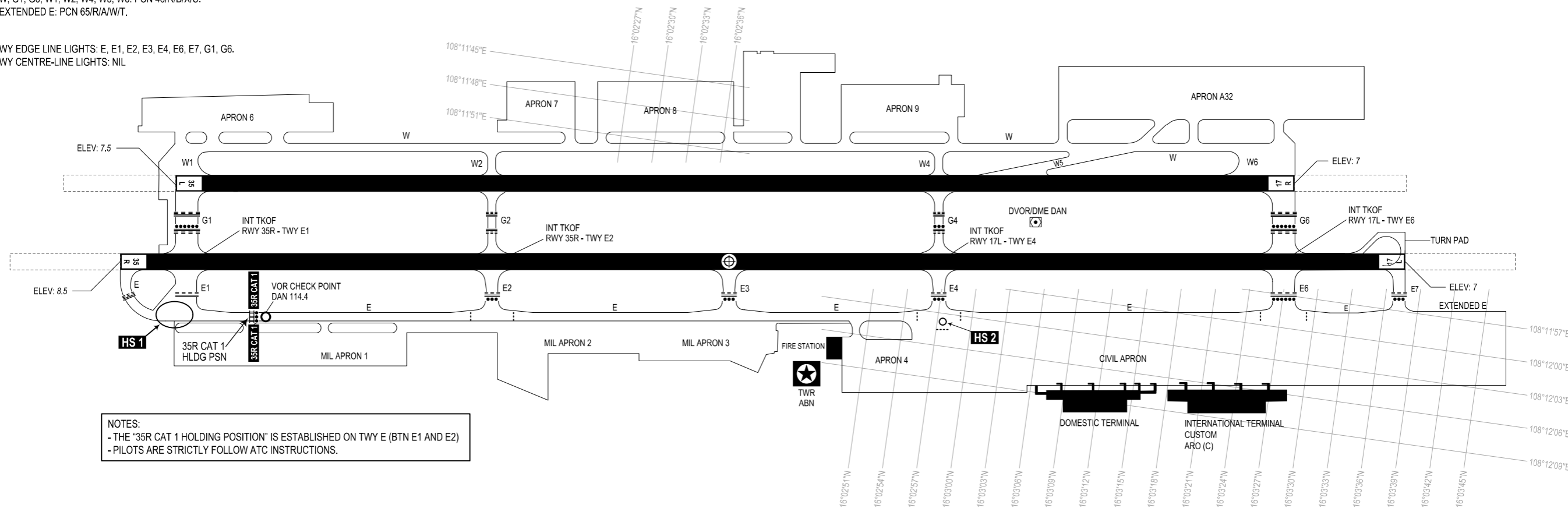
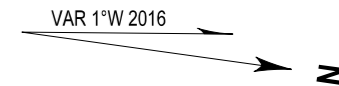

NOTES:
 - THE "35R CAT 1 HOLDING POSITION" IS ESTABLISHED ON TWY E (BTN E1 AND E2)
 - PILOTS ARE STRICTLY FOLLOW ATC INSTRUCTIONS.

LEGEND	
VOR CHECK POINT AND FREQUENCY	○ DAN 114.4
HOT SPOT AND NAME	○ HS 1
RWY-HOLDING POSITION (PATTERN A)	≡≡≡
RWY-HOLDING POSITION (PATTERN B)	≡≡≡
INTERMEDIATE HOLDING POSITION
STOP BAR	●●●
ARP	⊕

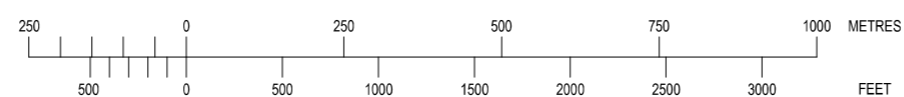

TAXI PROC FOR ACFT TAKE-OFF FROM INTERSECTION POSITIONS AS FLW:
 - INT TKOF RWY 17L - TWY E6: FROM APRON - E - E6
 - INT TKOF RWY 17L - TWY E4: FROM APRON - E - E4
 - INT TKOF RWY 35R - TWY E1: FROM APRON - E - E1 OR APRON - E - E6 - G6 - RWY 17R - G1
 - INT TKOF RWY 35R - TWY E2: FROM APRON - E - E2