

ELEVATIONS AND DIMENSION IN METRES
BEARINGS ARE MAGNETIC



TAXIWAYS WIDTH:
- TWYS W1, E1: 23M
- TWY SP: 18M

TAXIWAY BEARING STRENGTH:
- TWYS W1, E1: PCN 55/F/B/W/T
- TWY SP: PCN 45/F/B/W/T

APRON BEARING STRENGTH:
- OLD APRON (STANDS 1, 2, 3, 4, 5): PCN 45/R/B/W/T
- NEW APRON (STANDS 6, 6A, 6B, 7, 8, 9, 10, 11, 12, 13): PCN 66/R/A/W/T

TWY EDGE LIGHTS ON W1, E, SP.

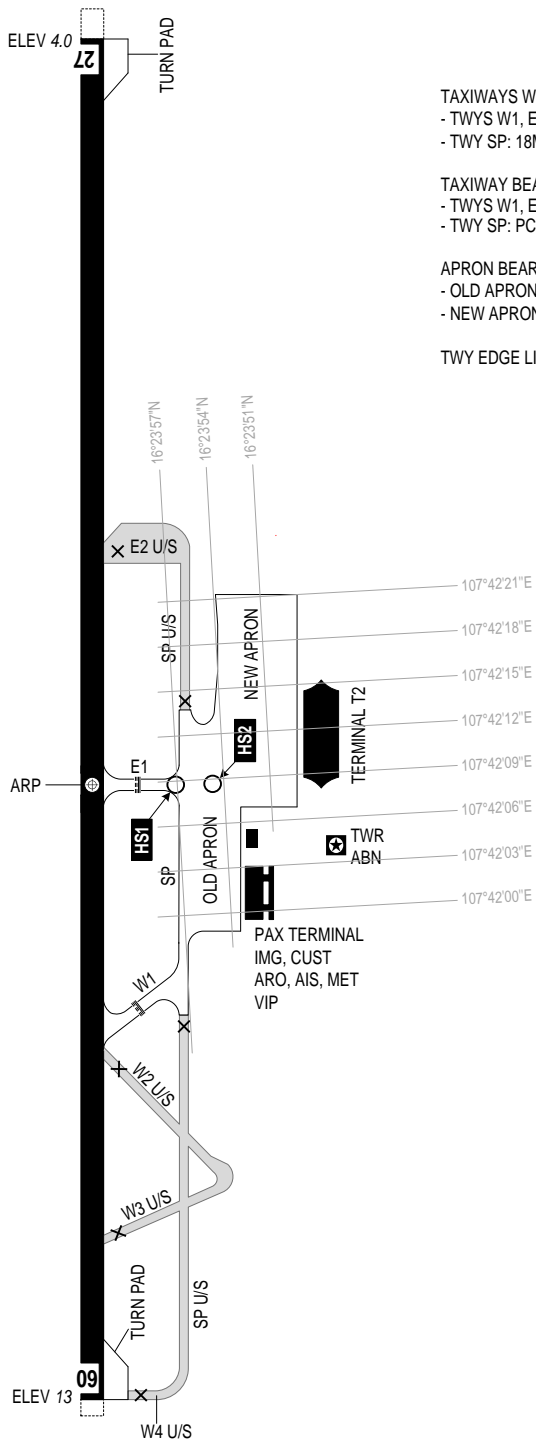

HP1: INTERSECTION BETWEEN TWY E1, TWY SP AND TAXILANE D1.
HP2: INTERSECTION BETWEEN TAXILANE D AND TAXILANE D1.

SCALE 1: 15 000
METRES

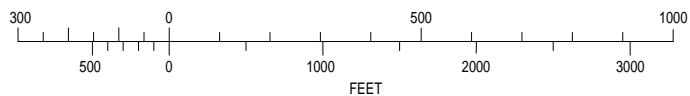

LEGEND

HOT SPOT AND NAME	HS1 → ○
BUILDINGS	■
RWY-HOLDING POSITION (PATTERN A)	≡≡≡
UNSERVICABLE (U/S)	▭
CLOSED	✕